

Electric Pallet truck

15/18/20EP



■ photo may include optional equipment.

Standard Configurations

15EP

- Lifting Capacity : 1,500kg
- DC Brushless Drive Motor 0.9kW
- Lifting Motor : 0.8kW
- Drive Wheel : Φ 195x70mm
- Double Fork wheel : Φ 80x70mm
- Hourmeter, Battery Discharge Indicator (BDI) & lift cut off
- Overall Fork Width x Length : 550mm x 1,150mm
- Turtle mode switch
- Built-in Charger
- Curtis Tiller with Convenient Control buttons
- Emergency switch
- Belly switch

18EP

- Lifting Capacity : 1,800kg
- AC Drive Motor 1.2kW
- Lift motor 1.2kW
- Curtis controller
- Drive wheel : Φ 250x70mm
- Double Fork wheel : Φ 80x70mm
- Hourmeter, Battery Discharge Indicator (BDI) & lift cut off
- Overall Fork Width x Length : 550mm x 1,150mm
- Turtle mode switch
- Curtis Tiller with Convenient Control buttons
- Side Battery Removal
- Emergency switch
- Belly switch

20EP

- Lifting Capacity : 2,000kg
- AC Drive Motor 1.2kW
- Lift motor 1.2kW
- Curtis controller
- Drive wheel : Φ 250x70mm
- Double Fork wheel : Φ 82x98mm
- Hourmeter, Battery Discharge Indicator (BDI) & lift cut off
- Overall Fork Width x Length : 550mm x 1,150mm
- Turtle mode switch
- Curtis Tiller with Convenient Control buttons
- Side Battery Removal
- Emergency switch
- Belly switch

Advantages

SAFETY AND PRODUCTIVITY

- Advanced AC control system eliminates directional contactors, which brings minimal maintenance requirements. (18/20EP Only)
- Intelligent regenerative brake system: increase overall truck performance.
- Side-way battery with roll-out system. (18/20EP Only)
- Emergency switch.
- Turtle mode switch
- Proportional Travel speed control.
- Belly switch.

STRUCTURAL

- The motor structure is water-proof and dust-proof(IP 44)
- Spring-loaded castors improve lateral stability on uneven floors and enhance truck performance and service life.
- Welded type fork

SERVICEABILITY

- CANbus technology reduces wiring complexity.
- All pivot points have grease fitting and serviceable to reduce component-wearing

Tiller Head



Curtis Tiller with convenient control buttons (standard)



Germany Frei Tiller (option)

Dimension

15EP

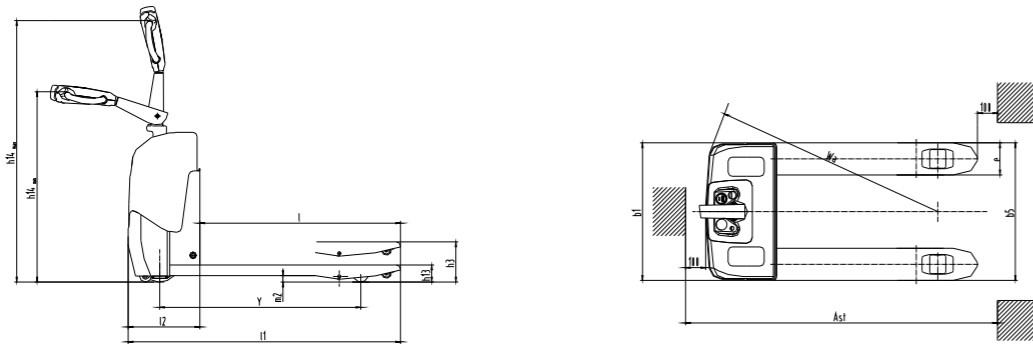

18/20EP

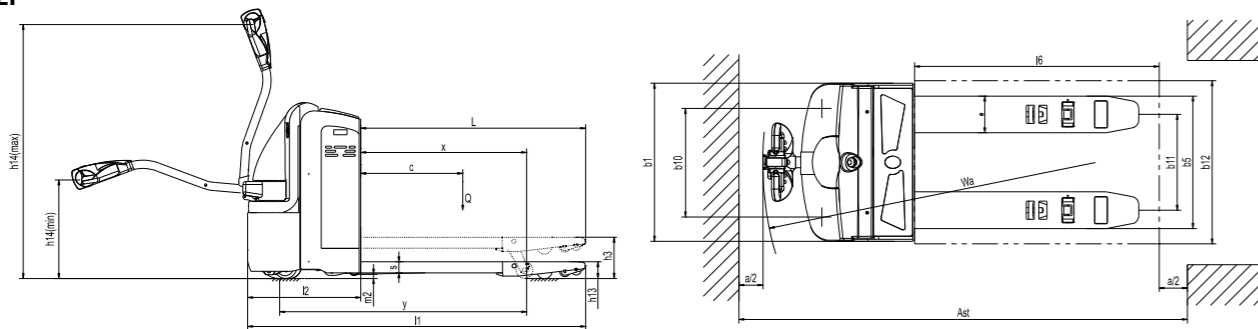

Option

15EP

- Load backrest 1220mm
- Fork length (mm)
900, 1000, 1150, 1220
- German Frei Tiller
- Single Fork Wheel (∅80x93mm)
- Overall Fork width x length : 520x1,150mm

18EP

- Single Fork Wheel (∅82x98mm)
- Cold Storage Specifications -18°C
- Battery (24V/160Ah)
- Integrated Charger (24V/15A)
- Separate Charger (24V/15A)
- Foot protection strip
- Key pad ignition
- Load backrest 1220mm
- Fork length(mm)
800, 900, 1000, 1150, 1220, 1600, 1800, 2400mm
(1800, 2400 : rated load capacity 1.5t)
- German Frei Tiller

20EP

- Single Fork Wheel (∅82x126mm)
- Battery (24V/210Ah)
- Battery (24V/240Ah)
- Integrated Charger (24V/20A)
- Separate Charger (24V/30A)
- Battery trolley
- Cold Storage Specifications -18°C
- Foot protection strip
- Key pad ignition
- Load backrest 1220mm
- Fork length(mm)
800, 900, 1000, 1600, 1800, 2400mm
(1,800, 2,400 : rated load capacity 1.5t)
- German Frei Tiller
- Overall Fork width x length : 550X1150mm

Specifications (according to VDI 2198)

Characteristics						
1.1	Manufacturer(abbreviation)		Hyundai	Hyundai	Hyundai	
1.2	Model		15EP	18EP	20EP	
1.3	Drive type		electric	electric	electric	
1.4	Operator type		pedestrian	pedestrian	pedestrian	
1.5	Load capacity/rated load	Q	kg	1500	1800	2000
1.6	Load center distance	c	mm	600	600	600
1.8	Load distance	x	mm	886	856	865
1.9	Wheelbase	y	mm	1152	1200	1261
Weight						
2.1	Service weight(with battery)		kg	230	520	620
2.2	Axle load, front/rear, laden		kg	442/1288	720/1600	1170/1450
2.3	Axle load, front/rear, unladen		kg	200/30	420/100	470/150
Wheels/Chassis						
3.1	Tyres: solud rubber, superelastic, pneumatic, polyurethane			polyurethane	polyurethane	polyurethane
3.2	Tyre size, front			∅ 195x70	∅ 250x70	∅ 250x70
3.3	Tyre size, rear			∅ 80x 70	∅ 80x70	∅ 82x98
3.4	Additional wheels(dimensions)			∅ 60x35	∅ 114x60	∅ 127x57
3.5	Wheels number, front/rear (x = driven wheels)			1x2/4	1x+2/4	1x+2/4
3.6	Tread, front	b10	mm	195	476	510
3.7	Tread, rear	b11	mm	390	400	370
Dimension						
4.4	Lift height	h3	mm	105/115	120	120
4.9	Min. /Max. height of operation handle, in driving position	h14	mm	950/1310	780/1230	780/1230
4.15	Height, lowered	h13	mm	85/75	84	82
4.19	Overall length	l1	mm	1525	1651	1705
4.20	Length to fork face	l2	mm	373	500	555
4.21	Overall width of truck body	b1	mm	685	682	775
4.22	Fork dimension	s/e/l	mm	53/160/1150	54/150/1150	54/180/1150
4.25	Overall width of fork	b5	mm	550	550	550
4.32	Wheelbase ground distance	m2	mm	32/22	28	28
4.33	Aisle width, with pallet 1000x1200 crosswise	Ast	mm	1725	1863	2065
4.34	Aisle width, with pallet 800x1200 lengthwise	Ast	mm	1775	1913	2115
4.35	Turning radius	Wa	mm	1347	1367	1450
Performance Data						
5.1	Traveling speed, laden/unladen		km/h	5.8/6.0	5.8/6.0	5.8/6.0
5.2	Lifting speed, laden/unladen		m/s	0.035/0.045	0.06/0.11	0.039/0.056
5.3	Lowering speed, laden/unladen		m/s	0.08/0.037	0.12/0.13	0.064/0.050
5.7	Gradeability, laden/unladen		%	5/15	8/20	6/12
5.10	Traveling brake			electromagnetic brake	electromagnetic brake	electromagnetic brake
Motor						
6.1	Driving motor power		kW	0.9	1.2	1.2
6.2	Lifting motor power		kW	0.8	1.2	1.2
6.4	Battery voltage/rated capacity		V/Ah	24/80	24/160	24/210
6.5	Battery weight		kg	49	160	196