

Hyundai 9 Series diesel forklift

300D-9



Some of the photos may include optional equipment

Your satisfaction is our priority.

Proven technology! Hyundai 9 Series diesel forklift

The Hyundai 9 Series big diesel forklift is ready for the customers. Overwhelming the worksite with its superior performance and providing optimal fuel efficiency, the Hyundai 9 Series big diesel forklift offers outstanding durability based on its application of high-quality hydraulic and functional components suitable for large and heavy load duties, as well as comfortable and pleasant driving space, and convenient after-sales management.

Excellent performance

- Eco-friendly, powerful, 204.5kW Cummins QSL9 engine
- Fully automatic ZF electronic transmission with 3 forward-reverse shifts
- Wet disc brake & Kessler drive axle with planetary final reduction gears
- 3-stage TS mast (STD)

Ensured safety at the logistics site

- Auto parking brake
- Real-time notification of rear wheel steering angle
- Operator presence sensing system (OPSS)

Comfortable and safe driving

- Deluxe cabin equipped with fully automatic air conditioning
- Hydraulic pilot valve lever
- Load weight indicator (OPT)
- Password starting system
- Side shift & Fork positioner (STD)

Convenient management

- One-touch electric motor-driven tilting cabin
- Notification of replacement of the consumable items
- Engine fault diagnosis



Power & Performance

High Efficiency,
Optimal
Performance

Robust, refined, and luxurious design – 300D-9!
Offering increased power and fuel economy,
this model will be your best partner in
any work environment.



Some of the photos may include optional equipment

Powerful and economical
Cummins QSL9 Engine

The six-cylinder QSL9 engine, equipped with the German Bosch’s fuel system proven for its reliability and durability, shows lower vibration compared to other engines, delivers excellent cold-start performance, and does not emit white smoke in the winter. Moreover, its combination with the ZF transmission, optimized in fuel injection control and improved in driving efficiency, further enhances fuel efficiency and performance. In particular, you can experience increased power during operations due to its high torque at low and medium speeds, and DOC and SCR emission aftertreatment systems have been applied to satisfy Tier 4 final(Euro stage IV) (requires urea solution).



•204.5kW/2,200rpm •124kgf.m/1,500rpm

Gradeability and travel speed

With the best engine power, it delivers outstanding running performance and exceptional gradeability, ensuring stable operation at high speeds, on rough terrains and slopes.

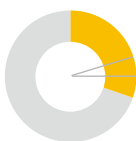

Max. Gradeability (Loaded)



Max. Travel Speed (Unloaded)



ZF Full-automatic transmission

Due to optimized engine and performance of the transmission, acceleration performance in low-speed sections has improved and noise heat generation has reduced. Also, it is possible to check the transmission status/failure etc. on the display window of the cluster.



Drive axle & Wet disc brake

Kessler’s high capacity drive axle, the planetary gear type, enables outstanding power transmission and shows exceptional adaptability to sudden changes in torque. Also, wet-type multi-plate service brake delivers consistent braking power when operations are repeated.



Hydraulic steering axle

The hydraulic steering system allows light and easy operation control without overruns or kickbacks caused by the road profile. Taper roller bearings and ADI knuckles with excellent strength and wear resistance are used in consideration of heavy load operation. The newly added protector prevents damage of rear wheel hub bolts.

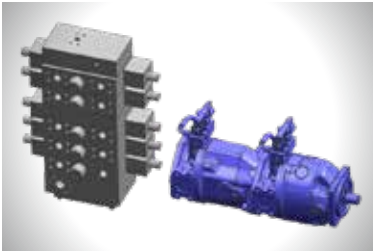

Load sensing hydraulic system

Hydraulic system consisting of a Bosch’s swash plate piston pump and control valve optimizes energy consumption and increases durability of engine and transmission.

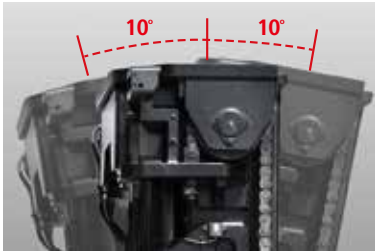

Mast Tilting Angle

Tilting speed is improved by combining some hydraulic pressure generated from the secondary pump to the primary pump flow rate. The tilting angle of 10 degrees forward and 10 degrees backward increases work efficiency.

Engine mode control

Engine performance can be adjusted to suit the workload, simply by operating a switch mounted on the side panel.
STD mode : Light load operations (fuel saving mode)
PWR mode : Operations on slope Requiring intense power

Low engine RPM conversion

Depending on the need, the driver can convert the engine to a low RPM. The RPM will return to its initial settings value once engine is stopped and restarted.



3-stage T/S mast

The 4.7m T/S(Triplex Separated Full Free) mast is adopted as a standard to enable better handling of large and heavy work and wider visibility. Also, it adopts BL2066 chain and chain sheave bearings with 70% improved dynamic load capacity compared to the 250D-9.

Easy & Comfort

Comfortable Workspace Intuitive Monitoring

Ergonomically designed workspace for operator provides the best comfort in any type of operation.



Some of the photos may include optional equipment

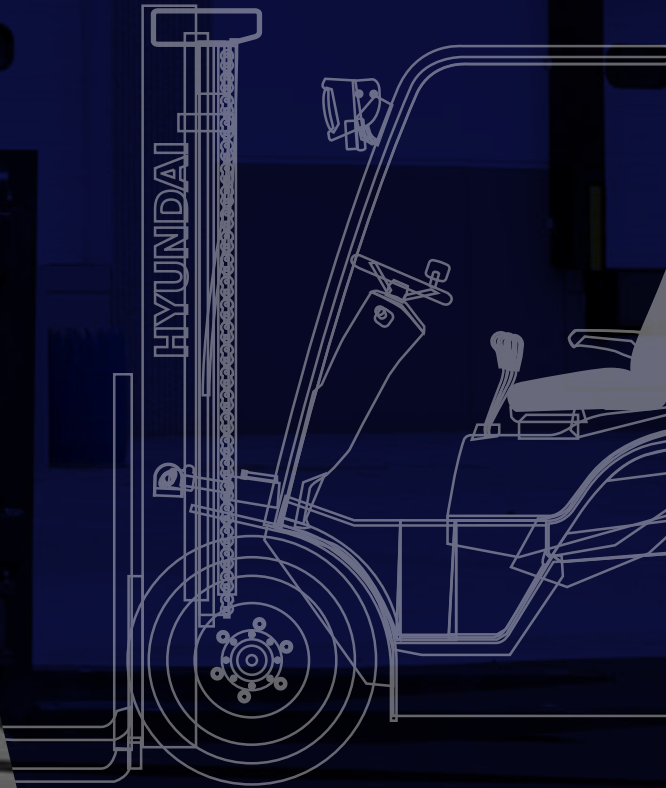

Ergonomic operating space

The ergonomically designed operating space was made for more space, a wider field of view and operator comfort. The smooth lever and pedal operation, adjustable tilting handle, suspension seat and deluxe cabin provide comfortable and efficient operation.



Some of the photos may include optional equipment



Full air suspension seat (OPT)

Ergonomically designed to support a comfortable posture, the full suspension seat relieves fatigue and enables greater comfort for operation.

New style & centralized cluster

The TFT LCD color monitor indicates real-time driving information and changing vehicle stability depending on the work condition, thus allowing easy and efficient control for the operator. Diagnostic error codes allow easy trouble-shooting and the operator can select various performance modes.



Main Functions

- Urea level gauge
- T/M information display
- Parking brake indicator
- Battery charging failure warning
- Brake system overheat warning
- Air cleaner filter warning
- Machine inclination warning
- Load weight indicator
- Steering wheel position
- Engine coolant temperature warning
- Engine check warning lamp
- Seatbelt warning
- Exchange consumable indicator
- Mast tilt angle indicator
- High beam indicator
- T/M error warning
- OPSS indicator
- Inching indicator



Fully automatic air-conditioner

The air-conditioner automatically adjusts temperature to the set temperature and provides more comfortable working environment for the operator.



Responsive levers

Responsive levers with the latest hydraulic system enables micromanipulation and excellent performance. (5-Lever, 6-Function : STD / 7-Function : OPT)



Ergonomic pedals

The high-quality floor mat and ergonomically designed pedal arrangement reduce operator fatigue and drastically improve productivity.

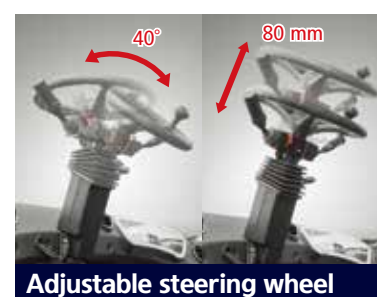

Adjustable steering wheel

The steering wheel can be pushed forward or backward, pushed in or out to suit the driver's body shape, providing an all the more comfortable work environment.



Integrated communications controller

Cutting-edge communications technology enhances the operator convenience (Bluetooth hands-free, cellphone call, radio communication, USB/MP3 audio control functions).

Secure & Safety

Excellent visibility Advanced safety

The safely designed driver's space makes your operating more comfortable.

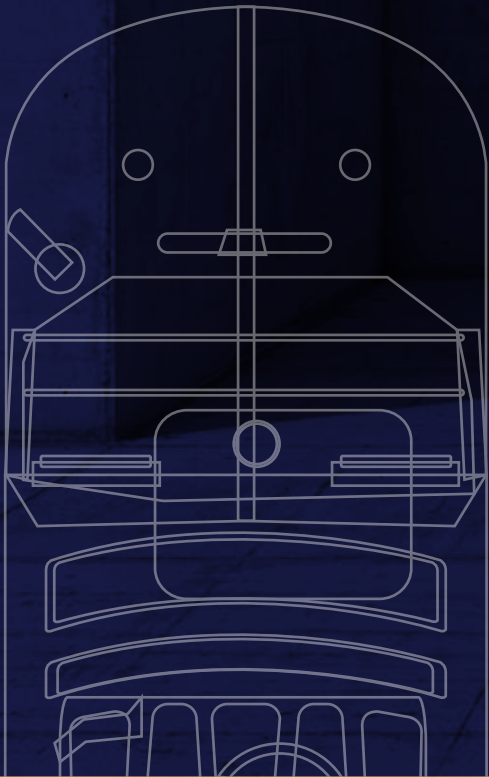

Some of the photos may include optional equipment



Excellent visibility for safe operation

Optimized lift cylinder arrangement provides the operator with wider visibility.
A panoramic mirror expands the driver's rear view.



Some of the photos may include optional equipment

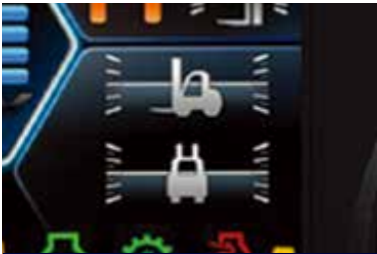

Machine inclination warning system
The grade (left) and slope (right) sensors are built into the MCU and provide the grade and slope status information of the vehicle connected with the road surface condition in real time. Also, an alarm is emitted when the KS regulation is exceeded.



Steering wheel position
As a measurement of the steering angle sensor, which is installed on the kingpin of the rear axle, is displayed on the large cluster screen as an image, the operator can predict the direction of the vehicle without difficulty.



Load weight indicator (OPT)
When lifting a load, a change in hydraulic pressure of the lift line is converted to a measurement of weight displayed in real time, and a warning is given at the time of overload.

Safety features

The adoption of a high-sensitivity sensor and advanced safety system eliminates the risk of safety accidents.

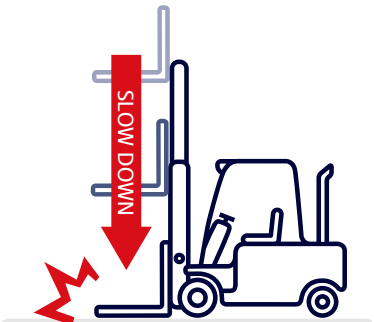

Fork Safety Features
The down-safety valve prevents forks from dropping down in case of sudden damage of hydraulic line.



Auto parking brake
If the operator leaves the seat while the gear lever is in neutral, the parking brake is automatically engaged to secure safety, and released upon the operator's return to the seat.

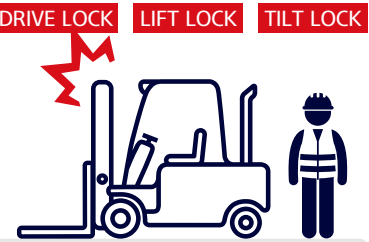

Operator presence sensing system
All mast and drive movements stop functioning when the operator is not in the seat.

Speed limit setting
The operator can set and limit the maximum speed from 10km/h to 30km/h.

Password starting system
The operator can set a passcode to prevent vehicle theft and possible safety accidents in case the vehicle is used by an unauthorized person.
(Up to 10 passwords can be set.)



Increased night work efficiency
Four work lamps on the upper side of the mast, two headlamps on the frame fender, and two work lamps on the upper side of the counterweight enable efficient nighttime and indoor operations.



Maintenance & Convenience

Fast and Easy Maintenance & Convenience Features

An ideal arrangement of components ensures easy access and convenience for maintenance.

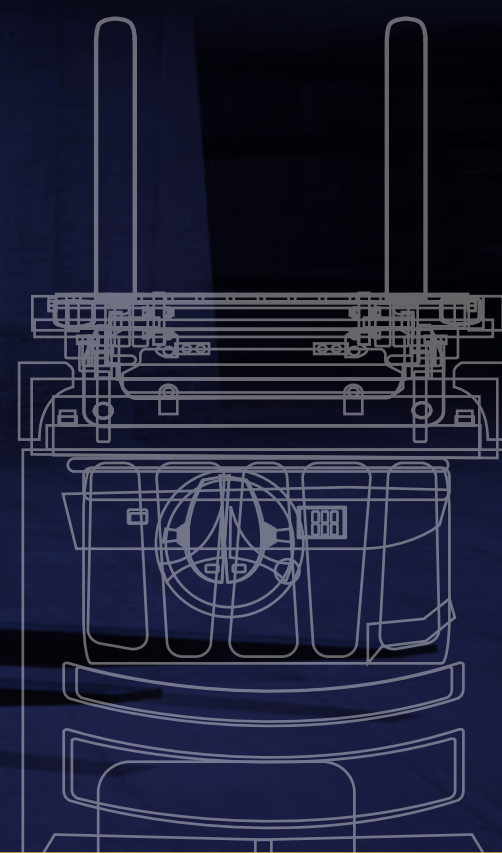

Some of the photos may include optional equipment.

Fully opening tilting cabin and hood

The tilting cabin that has been dramatically improved in its maintainability functions with a separate electric motor and hydraulic pump. By opening the cabin, which can be tilted to a maximum of 54 degrees, and the engine hood, which can be opened to the left or right, all functional components installed inside the chassis can easily be examined and serviced.



Some of the photos may include optional equipment.

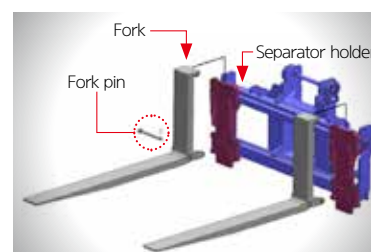

Separator holder carriage

To improve handling and easily switch forks and other attachment, separator holder system is adopted as option. It is possible to install various attachments easily.



Rear view camera

A rear view camera and monitor are linked to the reverse gear, ensuring safer rear work environment.



Up-to-date cooling system

Variable speed and remote controlled fans reduce required engine power and noise, while the aluminum cooler improves durability and heat output.



Battery master switch

Damage is prevented during inspection /maintenance of electronic units, and battery discharge.



Double-filtration air cleaner

The double-filtration air cleaner filter with large capacity enables longer filter life span. The operator can access the air filter easily by simply opening the engine hood.

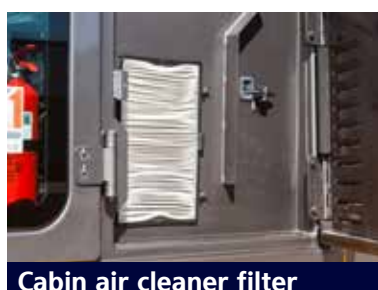

Cabin air cleaner filter

The air cleaner filter blocks external dust and noise from the cabin, and continuously supplies clean air indoor to maintain fresh air in the driving space.

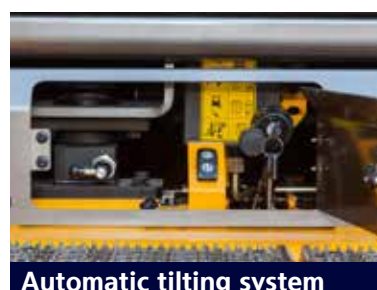

Automatic tilting system

The cabin tilting system allows the operator to tilt the cabin with a single switch up to 54 degrees, thus enabling easy maintenance of functional devices located under the driver seat.



Engine fault diagnosis

Details of engine fault diagnosed by the engine control unit (ECU) can be checked on the cluster.



Maintenance management

Replacement cycle of consumable items can be checked on the monitor, thus preventing performance deterioration of major functional parts due to failure to notice deterioration.

Mast specifications

Mast type	mm		deg	kg
	Maximum fork height	Overall mast height (lowered)	Tilting Angle Fwd / Bwd	Truck weight (unloaded)
2-stage mast	V345	3,486	12 / 10	30,000
	V400	4,040	12 / 10	30,000
	V450	4,540	12 / 10	30,000
	V500	5,040	12 / 10	30,000
	V550	5,540	12 / 10	30,000
	V600	6,040	12 / 10	30,000
3-stage mast	V650	6,540	12 / 10	40,560
	V700	7,040	12 / 10	40,850
	*TS470	4,712	10 / 10	30,000
	TS500	5,012	10 / 10	29,400
	TS530	5,312	10 / 10	29,000
	TS560	5,612	10 / 10	28,700
standard mast	TS600	6,016	10 / 10	28,300
	TS650	6,512	10 / 10	27,700

※ : Standard

Specification

Identification	mm		kg
	Load capacity	Load center	Maximum lift height ①
	30,000	800	4,712
	mm/sec	250 / 280	mm/sec
	Lowering speed, loaded / unloaded	400 / 300	mm
	Fork dimension L x W x H	2,450 x 250 x 110	mm
	Fork Carriage Width ⑭	2,950	mm
	Tilting Angle (forward ② / backward ③)	10 / 10	degree°
	Extended height ④ / Lowered height ⑤	6,500 / 3,400	mm
	Travel speed, unloaded	30.8	km/h
	Max. Gradeability, loaded	30.4 (17.0)	%(°)
	Turning Radius ⑥	5,864	mm
Basic	Max. Drawbar pull, loaded	225,872	N
	Service weight	41,320	kg
	Length to face of forks ⑦ / Overall width ⑧	6,521 / 3,070	mm
	Height of overhead guard (cabin) ⑨	3,278	mm
	Ground clearance ⑩ / Wheel base ⑪	290 / 4,250	mm
Engine	Tread, front ⑫ / rear ⑬	2,212 / 2,140	mm
	Manufacturer / Model	Cummins / QS19	-
	Engine power acc. to ISO 1585	204.5 / 2,200	kW/rpm
	Max. torque	124 / 1,500	kgf · m/rpm
	Displacement	8,849	cc

Load Capacity

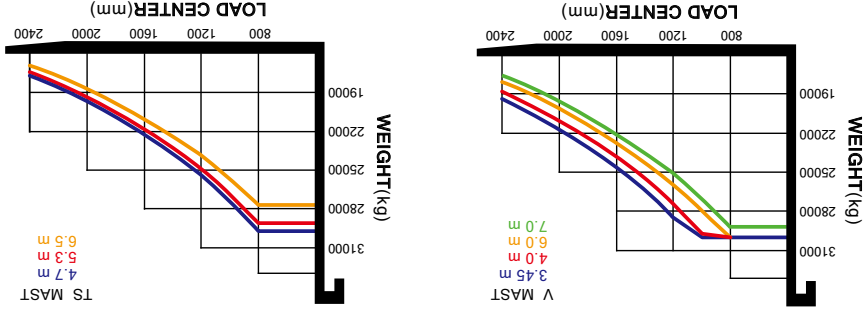

* The above specifications are based on side shift and fork positioner.

Optional Items

- Fork(m) 110 x 250 x 2,450(TD) / 110 x 250 x 1,800 / 110 x 250 x 2,700 / 110 x 250 x 3,150 / 110 x 250 x 3,650
- Seat : Leather + Seat heater
- Sliding carriage

Dimension

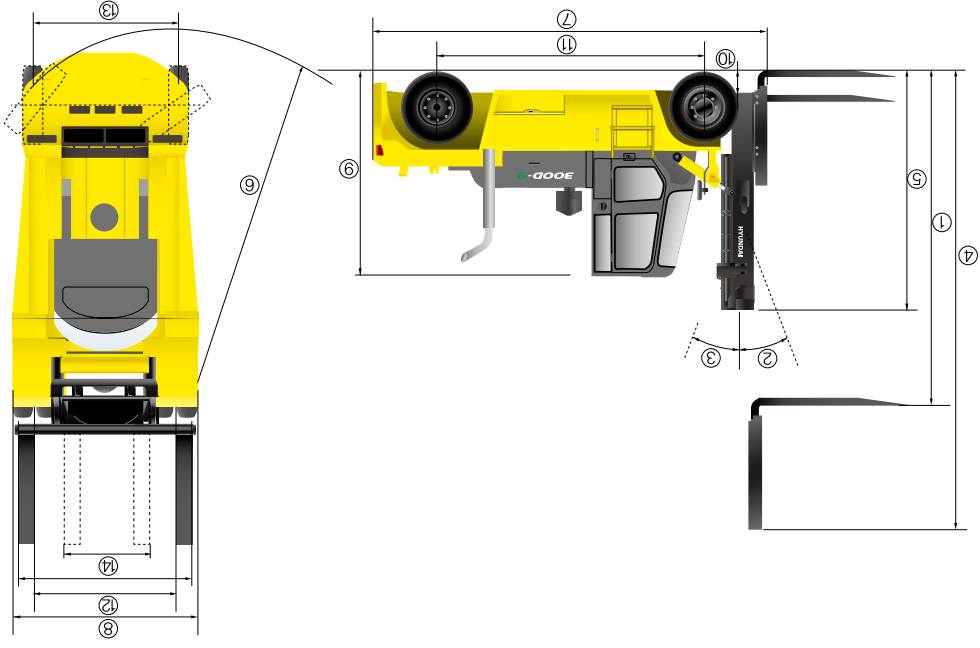

* Some of the data may change depending on optional equipment.